



# Handles, Locks & Latches



**ALT 561  
T HANDLE**  
(chrome plated)  
1/4 turn latch with key lock



**ALT 562  
WING KNOB KEY LOCK**  
(chrome plated)



**Z-2011  
WING KNOB KEY LOCK**



**ALL-509  
KEYED LATCH**



**ALL-508  
CHROME KEYED LATCH**



**ALL-503  
DIN 3 mm TYPE LATCH**  
(Non Metallic)



**LSK-502  
PLASTIC KEY FOR  
DIN 3 mm LATCHES**

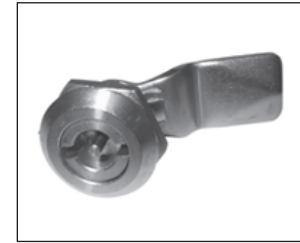

**ALLS-304  
DIN 3 mm TYPE LATCH**  
(Stainless)



**ALT 561XCE  
T HANDLE**  
(chrome plated) 1/4 turn latch



**Z-2034  
WING KNOB 1/4 TURN LATCH**



**Z-2033  
WING KNOB 1/4 TURN LATCH**



**Z-2031-A** – slot 1/4 turn (Vision Series)  
**Z-2031-B** – slot 1/4 turn  
(N12 & N4X Series)  
**ALLS-304** – Stainless DIN 1/4 turn  
(LSK503 DIN key not included)



# Handles, Locks & Latches



Locking cams for latches  
**Z-2050** – For use with N12 & N4 series  
(top image)  
**Z-2051** – For use with Vision series  
(bottom image)



**Z-3010 REPLACEMENT IB DOOR  
CLAMP HARDWARE**  
(2 per package)



**Z-3011 – REPLACEMENT N4 DOOR  
CLAMP HARDWARE**  
(2 per package)

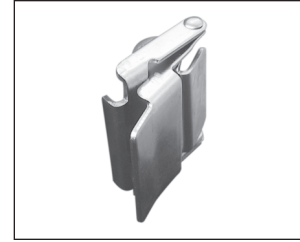

**IB SERIES  
QUICK RELEASE CLAMP**  
Replaces standard clamp  
(1 per package)  
**JH-40155** – Stainless Steel  
**JH-40165** – Plated Steel



**N4 SERIES QUICK RELEASE CLAMP**  
Replaces standard clamp screw  
(1 per package)  
**NH-40151** – Stainless Steel